

RG-MH PRO SERIES ON/OFF-GRID INVERTER WITH ENERGY STORAGE

RGB Light

RGB lighting for different working mode

RGB automatically switches with the working mode of the inverter:

Battery mode : red

Utility mode : blue

PV mode : purple

LCD Display

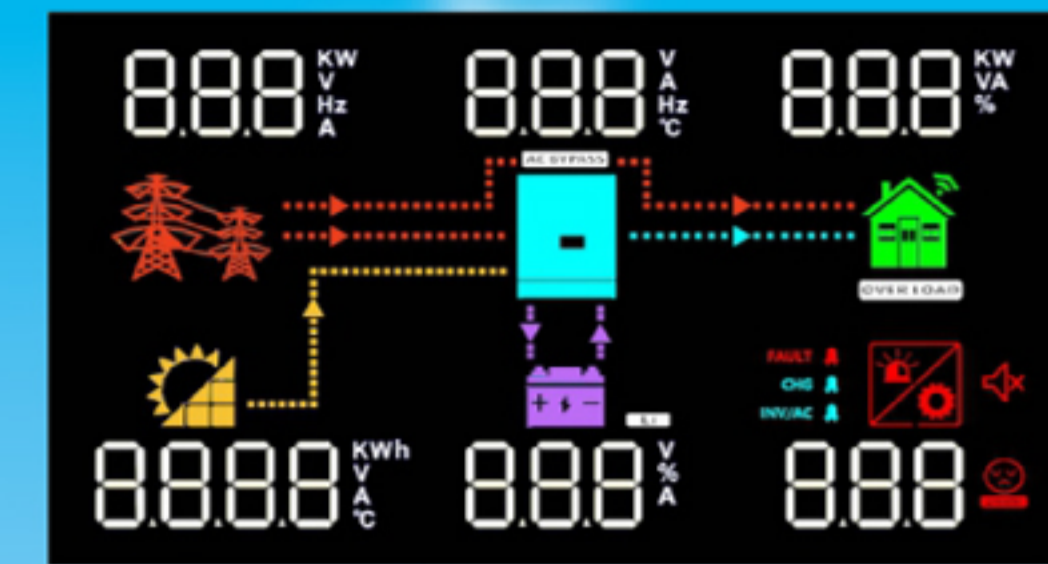

Features

- True sine wave solar inverter(on/off Grid)
- Output power factor 1.0
- WIFI&GPRS available for IOS and Android
- Inverter running without battery
- One-click restoration to factory Settings
- Built-in Lithium battery automatic activation
- Built-in 120A(for 3.6kw/6.2kw)/140A(for 4.2kw)
- MPPT:Max 6200w(for 3.6kw/4.2kw),max 6500w (for 6.2kw)solar charge
- High PV input voltage range(90~500VDC)Built-in anti-dusk kit for harsh environment
- Smart battery charge design to optimize battery 1 Dual output(V2.0)



RG-MH is a flexible and intelligent hybrid inverter which utilizes solar power, AC utility, and battery power source to supply continuous power. It's a simple and smart solar power storage system for home users to either store energy into a battery for night-time usage or use for self-consumption first depending on demands. Priority for power source is programmable through smart software. During night time or power failure, it will automatically consume reserved power from the battery. In this way, it will reduce dependence on the utility.



Save money by discharging battery for self-consumption first

RG-MH can save money by using battery energy first when PV energy is low. Until battery energy is low, RG-ISP will consume AC power from the grid.



Power backup when AC failed

RG-MH can operate as an off-grid inverter to provide continuous power even without the grid. It's a perfect power solution for remote regions or temporary AC power source for camping or night market.

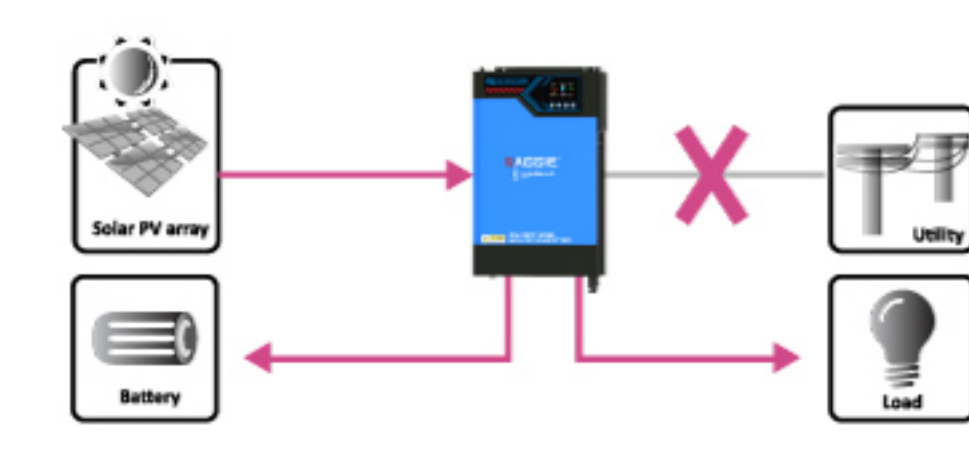

Feed-in is not the only choice

In comparison with conventional grid-tie inverter, RG-MH can not only feed-in power to the grid but also store solar power to the battery for future usage and directly power to the loads.

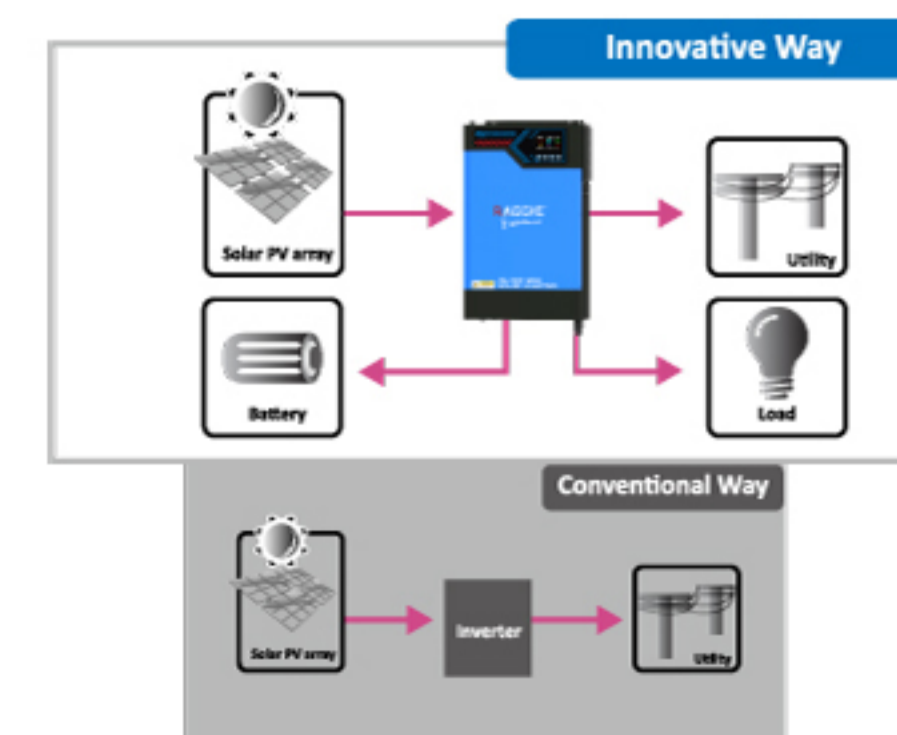

MODEL	RG-MH 3600W PRO	RG-MH 6200W PRO
Phase	1-phase	
Maximum PV Input Power	6200W	6500W
Rated Output Power	3600W	6200W
Maximum Solar Charging Current	120A	120A
GRID-TIE OPERATION		
PV Input(DC)		
Nominal DC Voltage/Maximum DC Voltage	360VDC/500VDC	
Start-up Voltage/Initial Feeding Voltage	90VDC/120VDC	
Maximum DC Voltage	90~450VDC	
Number of MPPT Trackers/Maximum Input Current	1/27A	
GRID OUTPUT(AC)		
Nominal Output Voltage	200/230/240VAC	
Output Voltage Range	195.5~253VAC	
Nominal Output Current	15.7A	27.0A
Power Factor	>0.99	
Feed-in Grid Frequency Range	59~61±1Hz	
EFFICIENCY		
Maximum Conversion Efficiency(Solar to AC)	98%	
TWO LOAD OUTPUT POWER(V2.0)		
Full Load	3600W	6200W
Maximum Main Load	3600W	6200W
Maximum Second Load(battery mode)	1200W	2067W
Main Load Cut Off Voltage	22VDC	44VDC
Main Load Return Voltage	24VDC	48VDC
OFF-GRID OPERATION		
AC INPUT		
AC Start-up Voltage/Auto Restart Voltage	120-140VAC/180VAC	
Acceptable Input Voltage Range	90-280VAC or 170-280VAC	
Maximum AC Input Current	30A	40A
Nominal operating frequency	50/60Hz	
Surge power	7200W	12400W
BATTERY MODE OUTPUT(AC)		
Nominal Output Voltage	24VDC	48VDC
Output Waveform	Pure sine wave	
Efficiency(DC to AC)	94%	
BATTERY & CHARGER		
Nominal DC Voltage	24VDC	48VDC
Maximum Charging Current (Solar to AC)	120A	120A
Maximum AC Charging Current	100A	
GENERAL		
PHYSICAL		
Dimension,D x W x H(mm)	420*310*110	
Net Weight(kgs)	10	11
INTERFACE		
Communication Port	RS232/WIFI	
ENVIRONMENT		
Humidity	5%~95%	
Operating Temperature	-10 ~50°C	